

- 1.) INGRESS & EGRESS EASEMENT BEING THE NORTH 12.00 FEET OF THE WEST 7.00 FEET OF THE EAST 29.00 FEET OF LOT 7 FOR THE USE OF THE EAST 22.0 FEET OF LOT 7. RECORDED BOOK 1964, PAGE 144, RECORDED AUGUST 11, 2006.
- 2.) AGREEMENT FOR 5'X52' LIGHT AND VENTILATION OPEN AREA RECORDED IN BOOK 24, PAGE 24B, RECORDED APRIL 11, 1884.
- 3.) INGRESS & EGRESS EASEMENT FOR JOINT STAIRWELL PURPOSES, NO SIZE SPECIFIED, RECORDED IN BOOK 24, PAGE 24B, RECORDED IN APRIL 11, 1884.

LEGEND

- FOUND REBAR WITH 1 1/2" ALUMINUM CAP STAMPED "SSS P.L.S. 2500" WITNESS CORNER AT THE EXTENSION OF THE PROPERTY LINES.
- (M) DENOTES DATA MEASURED THIS SURVEY
- (R) DENOTES DATA OF RECORD
- ⊕ EXISTING TELEPHONE MANHOLE
- ⊞ EXISTING CATCH BASIN
- ⊞ EXISTING GAS VALVE
- ⊞ EXISTING LIGHT POLE
- ⊞ EXISTING STORM SEWER MANHOLE
- ⊞ EXISTING SANITARY SEWER MANHOLE
- BE— EXISTING BURIED ELECTRIC LINE
- W— EXISTING WATER LINE
- SA— EXISTING SANITARY SEWER LINE
- ST— EXISTING STORM SEWER LINE
- OE— EXISTING OVERHEAD ELECTRIC LINES
- O— EXISTING CHAIN LINK FENCE
- GL— EXISTING GAS LINE
- BT— EXISTING BURIED TELEPHONE LINE
- ⊞ EXISTING CONCRETE SURFACE

CERTIFICATE OF SURVEYOR

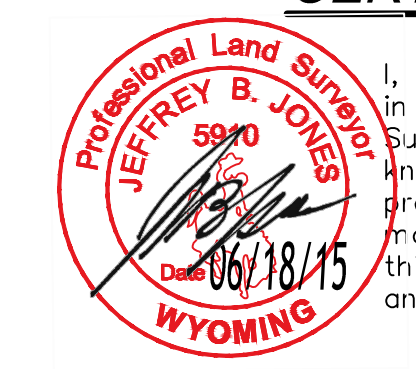

I, Jeffrey B. Jones, Registered Professional Land Surveyor in the State of Wyoming, for and on behalf of Steil Surveying Services, LLC, hereby state, to the best of my knowledge, information and belief, that this map was prepared from field notes taken during an actual survey made by me or under my direct supervision; and that this map correctly shows the results of said survey and that the monuments found or set are as shown.

TOPOGRAPHIC SURVEY FOR CHEYENNE CHILDRENS MUSEUM

LOT 1, BLOCK 1, MARRIOTT SUBDIVISION AND THE EAST 22 FEET OF LOT 7, BLOCK 390, ORIGINAL CITY, CITY OF CHEYENNE, LARAMIE COUNTY, WYOMING.

PREPARED JUNE, 2015

STEIL SURVEYING SERVICES, LLC
PROFESSIONAL LAND SURVEYORS
 1102 WEST 19th ST. CHEYENNE, WY. 82001 • (307) 634-7273
 756 GILCHRIST ST. WHEATLAND, WY. 82201 • (307) 322-9789
 www.SteilSurvey.com • info@SteilSurvey.com